



Half Moon Lane, SE24 | £300,000

02087029555

hernehill@pedderproperty.com

pedder
NEW HOMES



In General

- Prestigious development
- Spacious reception room
- Double bedroom
- Communal gardens
- Close to transport links
- No onward chain

In Detail

We are delighted to offer to the market this spacious one double bedroom first floor flat within Dulwich Mead, a prestigious retirement development, just off Half Moon Lane. The property is neutrally decorated throughout and is offered to the market with no onward chain.

The dual aspect reception room has a large bay window and a further side window. The kitchen has a modern range of wall and base units and an integrated oven and hob. The bedroom has a double built in wardrobe with sliding doors and there is a walk-in shower cubicle in the bathroom. Dulwich Mead benefits from a vast communal garden; parking bays for residents and visitors (non-allocated); a large communal reception room for social gatherings and an on-site Estate Manager.

The property is conveniently located between Herne Hill & Dulwich Village, both with a popular selection of restaurant & shopping amenities. Herne Hill station serves the property with services into Victoria, Thameslink, Blackfriars, as well as Southern, Southeastern & Thameslink services available from North Dulwich station. Elm Lodge surgery can be found on Burbage Road, alongside the delights of Brockwell Park with its cafe & lido being accessible.

EPC: B | Council Tax Band: C | Lease: 90 years remaining | SC: £3,975.24 | GR: Nil | BI: Incl. in SC

1

2

3

4

5

6

7

8

9

10

11

12



Floorplan

Dulwich Mead, SE24

Approximate Gross Internal Area
47.4 sq m / 510 sq ft

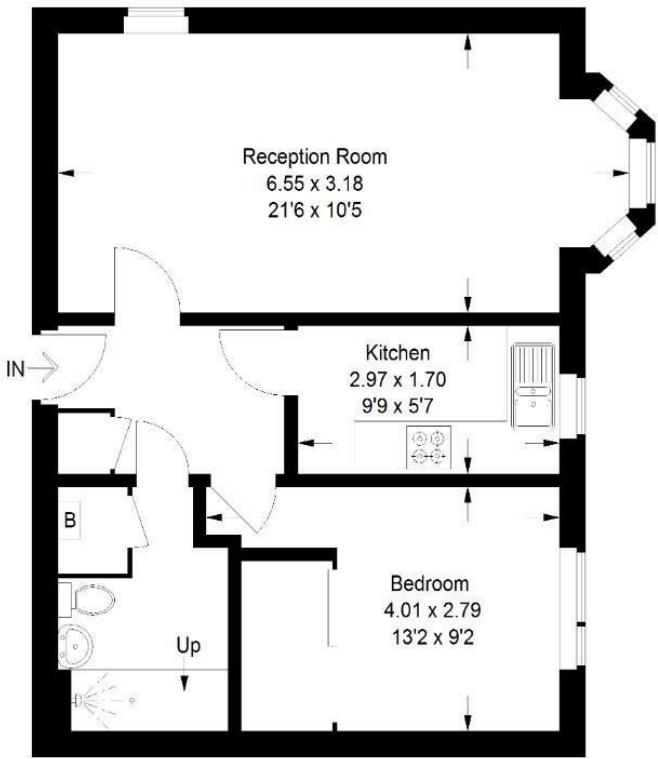

First Floor

Copyright www.pedderproperty.com © 2024
These plans are for representation purposes only as defined by RICS - Code of Measuring Practice. Not drawn to Scale. Windows and door openings are approximate. Please check all dimensions, shapes and compass bearings before making any decisions reliant upon them.

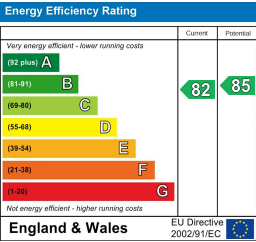

Pedder Property Ltd trading as Pedder for themselves and for the vendor/landlord of this property whose agents they are, give notice that (1) these particulars do not constitute any part of an offer or contract, (2) all statements contained within these particulars are made without responsibility on the part of Pedder or the vendor/landlord, (3) whilst made in good faith, none of the statements contained within these particulars are to be relied upon as a statement of representation or fact, (4) any intending purchaser/tenant must satisfy him/herself by inspection or otherwise as to the correctness of each of the statements contained within these particulars, (5) the vendor/landlord does not make or give either Pedder or any person in their employment any authority to make or give representation or warranty whatsoever in relation to this property.